

NANOCAM+^{PLUS}

USER MANUAL



Front, Rear & In-Cabin Dash Camera
with Day/Night Interior Recording & GPS



Connecting your drive.

NCP-DVR30CH

CONTENTS

| | | |
|------------|--|-----------|
| 1.0 | CAUTION | 4 |
| 1.1 | PRODUCT INFORMATION | 6 |
| 2.0 | INTRODUCTION | 6 |
| 2.1 | PACKAGE CONTENTS | 7 |
| 2.2 | PRODUCT OVERVIEW | 8 |
| 3.0 | BUTTON FUNCTIONS | 9 |
| 4.0 | GETTING STARTED | 11 |
| 4.1 | INSERTING A MICRO SD CARD | 11 |
| 4.2 | REMOVING A MICRO SD CARD | 11 |
| 4.3 | INSTALLING THE NCP-DVR30CH FRONT DASH CAMERA | 12 |
| 4.4 | CONNECTING TO POWER | 13 |
| 4.5 | INSTALLING THE REAR CAMERA..... | 14 |

| | | |
|------------|---|-----------|
| 4.5.1 | INSTALLATION GUIDE..... | 14 |
| 4.5.2 | REAR CAMERA WIRING DIAGRAM..... | 15 |
| 4.5.3 | REAR CAMERA FEATURES | 16 |
| 5.0 | POWERING ON/OFF..... | 17 |
| 5.1 | AUTO POWER ON/OFF | 17 |
| 5.2 | MANUAL POWER ON | 17 |
| 5.3 | MANUAL POWER OFF | 17 |
| 5.4 | RESETTING THE DASH CAMERA..... | 17 |
| 6.0 | INITIAL SETTINGS..... | 18 |
| 6.1 | FORMATTING THE INSERTED MICRO SD CARD | 18 |
| 7.0 | SETTING THE TIME AND DATE | 19 |
| 8.0 | VIDEO MODE..... | 20 |
| 9.0 | INTERFACE | 20 |

| | | |
|-------------|--|-----------|
| 9.1 | VIDEO MODE | 21 |
| 9.2 | SETUP MENU | 21 |
| 10.0 | RECORD SETTINGS | 22 |
| 11.0 | PLAYBACK | 25 |
| 12.0 | SOFTWARE PLAYBACK | 26 |
| 13.0 | WARRANTY TERMS & CONDITIONS | 27 |
| 13.1 | INDEMNITY | 28 |
| 13.2 | WARRANTY AND WARRANTY DISCLAIMER | 28 |
| 13.3 | LIMITATIONS OF NANOCAM+ LIABILITY | 31 |
| 14.0 | NOTES | 32 |

1.0 CAUTION

- Ensure you are using your front, in-cabin, and rear Dash Camera within your country's road laws. Please make sure you are familiar with your local road legislation before use.
- Avoid leaving your Dash Camera in direct sunlight for extended periods of time in unventilated spaces.
- Please set up the time and date before you use this device to record.
- The notifications given by the Dash Camera are suggestions only, please drive to the actual conditions.
- The results of GPS positioning are for reference only. The Dash Camera will lose GPS positioning abilities when the signal is blocked (e.g. driving through tunnels or enclosed car parks).
- GPS positioning accuracy may vary depending on weather and surroundings such as high-density cities, tunnels or forests. GPS satellite signals cannot pass through most solid materials. Tinted windows may also affect the GPS signal.
- The values displayed in this system, such as speed, position and the distance warning, may be affected by the surrounding environment.
- The system is to be used only for non-commercial use, within the limits permitted by your country's relevant laws.

- Avoid using the Dash Camera near any devices that emit radio interference (e.g. microwave ovens). It is considered normal operation for the Dash Camera to get warm during use.

NOTES ON INSTALLATION

- It is advised that the front Dash Camera is installed near the rear view mirror and at the top centre of the windshield for optimal operation.
- Make sure that the lens is within range of the windscreen wiper to ensure a clear view when it rains.
- Do not touch the lens with your fingers. Fingerprints left on the lens will result in unclear videos or photos. If photos or videos are blurred, please clean the lens gently with a microfibre cloth.
- Do not install the device on a tinted window. Doing so may damage the tint film and restrict the Dash Camera's GPS signal.
- Make sure that the installation position does not hinder or block the field of view or GPS signal.
- Only use the included cable to power the Dash Camera.
- The Dash Camera is designed to be constantly connected to the included power supply.

1.1 PRODUCT INFORMATION

For the latest manual and product updates please visit our websites:

www.nanocamplus.com.au or **www.nanocamplus.co.nz**

2.0 INTRODUCTION

Thank you for purchasing a front, in-cabin and rear Nanocam+ Dash Camera. Please read through the instructions before attempting to install or use this product.

This User Guide is designed to assist with the day to day operation of the Dash Camera.

Before attempting to use or install your Dash Camera, please ensure you have read and understood all of the safety notes below:

- Do not expose your Dash Camera to liquids, excessively dusty conditions or temperatures exceeding 60°C.
- Only use the included cables to power and charge the Dash Camera.
- Please do not attempt to adjust the Dash Camera position or settings whilst you are driving your vehicle.
- Please clean the windshield thoroughly, removing all dust and dirt particles before fixing the adhesive mount.

- The mount sticks on the windshield with the 3M mount, please ensure that the camera is best located to capture the maximum view.
- We suggest you power-on the Dash Camera and test the playback image on screen prior to removing the 3M tape for installation.
- Only remove the 3M tape when you are satisfied that the Dash Camera placement and image position are delivering the best possible image and view of the road ahead.
- Ensure you are using your Dash Camera within your country's road laws. Please make sure you are familiar with your local road legislation before use.

2.1 PACKAGE CONTENTS



1x Front Dash
Camera with
in-cabin camera



1x Rear Camera
with 8m Cable



1x Car Charger



1x Spare 3M
Adhesive



1x User Guide



2x Electrostatic
Film



1x Micro SD card
Reader

2.2 PRODUCT OVERVIEW

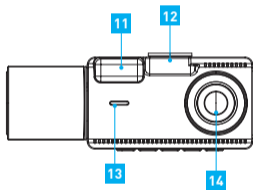
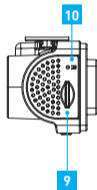
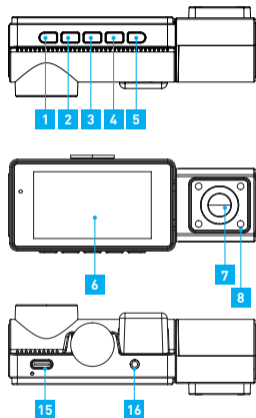

1. Power
2. Ok Button
3. Up Button
4. Menu/Mode Button
5. Down Button
6. Display
7. In-cabin Camera
8. IR Lights
9. TF Card Slot
10. Reset Button
11. GPS module
12. 3M Mount Slot
13. Speaker
14. Front Lens
15. Type-C Power Jack
16. AV in for Rear camera

3.0 BUTTON FUNCTIONS

POWER BUTTON

Press and hold the Power button to Power Off the device.

(Please note, when connected to power, the Dash Camera will automatically start recording).

Short press the Power button to turn on/off the display.

MENU & MODE BUTTON

Hold and press the M button to switch to Playback Mode.

Press the M Button to enter into the Record & System settings.

OK BUTTON

Press the OK button to start/stop recording.

(Please note, when connected to power, the Dash Camera will automatically start recording).

Press the OK button in menu settings to confirm the selection.

UP BUTTON

In the Settings menu use the Up button to toggle between settings.

Press Up button to switch the display.

Press Up button in recording mode to take photo.

▼ DISPLAY SWITCH, DOWN BUTTON

In the Settings menu, use the Down button to toggle between settings.
Press the Down button to turn the inbuilt microphone ON/OFF.
Hold and Press the Down button to switch Display.

R RESET BUTTON

Press to reset to factory settings.

MIC MIC

Microphone Position.

TF TF CARD SLOT

Micro SD Card Slot. Please use Maximum 128GB, U1 and above.

USB USB INTERFACE

Type-C USB socket to connect with Power Cable provided.

4.0 GETTING STARTED

4.1 INSERTING A MICRO SD CARD

With the Dash Camera turned off and the screen facing towards you, insert Micro SD card (not included) in the slot on the left side of the Dash Camera with the text on the Micro SD card away from you. Push the memory card in until a click is heard.

4.2 REMOVING A MICRO SD CARD

Ensure that the Dash Camera is powered off before using your thumbnail to press in the Micro SD card until a click is heard. The Micro SD card will then eject when released.

NOTE:

- Micro SD card is not included.
- Do not remove or insert a Micro SD card while the Dash Camera is turned on as this may damage the Micro SD card or corrupt the card's stored data.
- Please use a U1 or higher rated Micro SD card with a maximum capacity of 128GB.
- Please format the Micro SD card before initial use. (See section 6.1 for instructions on Formatting your Micro SD card).
- Be careful when removing the Micro SD card as it may eject quickly.

4.3 INSTALLING THE NCP-DVR30CH FRONT DASH CAMERA

1. Connect the window mount to the top of the Dash Camera and rotate the locking nut (See Fig 1 on page 14) clockwise until it is tight.
2. Please follow the instructions on page 6 before continuing.
3. Remove the protective stickers from the Dash Camera and the 3M Mount.
4. Press the mount base firmly against the windscreen and hold for 30 seconds.
5. Insert the power cable adaptor into the Dash Camera power socket.

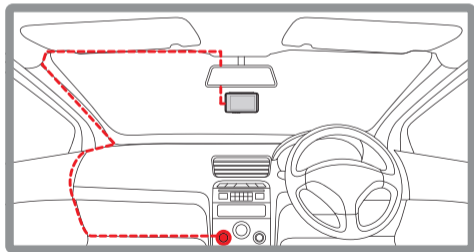

NOTE:

- It is advised that the Dash Camera is installed in the centre of the windscreen behind the rear view mirror.

(Fig .1) Installing the Dash Camera

4.4 CONNECTING TO POWER

Only use the included charger to power and charge the Dash Camera.

1. Once the Dash Camera is securely installed on your vehicle's windscreen, plug the DC Power Plug into your vehicle's cigarette lighter.
2. Run the power cable along the top and side of the windscreen and behind your glove box. Plug the Type-C USB plug into the Dash Camera and the DC Power Adaptor into your cigarette lighter port. (See Fig 1 on page 14).

NOTES:

- It is recommended that the Dash Camera is installed behind your vehicle's rear-view mirror and you format your Micro SD card the first time it is inserted. Please follow the Micro SD card Formatting instructions on page 20 Section 6.1. Quick Format.
- Make sure that the Dash Camera view is not obstructed by any window tint or any other objects.
- The NCP-DVR30CH is designed to be constantly powered by the included DC Power Plug.

4.5 INSTALLING THE REAR CAMERA

4.5.1 INSTALLATION GUIDE

1. Select the electrostatic film from the box and install it on the rear windshield in the recommended position as shown. Please wipe glass before installation and push out the bubbles between the static film and the glass before installation.
2. Remove the protective film from the rear camera base bracket and select either the top or the bottom of the rear window to position the rear camera.
3. Press  on the base of the bracket by hand for 30 seconds to ensure that the sticker adhesive has attached to the electrostatic film.

Connect the rear camera to the front Dash Camera using the cable provided and using Method 1 or 2 as shown below. The rear camera can rotate 360°degrees depending on the position and type of installation method.

Method 1: Thread the rear camera cable along the top of the roof lining and connect it to the front Dash Camera.

Method 2: Lift up the car carpet and run the rear camera cable along the underlay of the carpet and connect it to the front Dash Camera.

4. Adjust camera by rotating the barrel until it is capturing the entire road.

NOTES:

- While viewing your live footage on the DVR or on the Dash Camera, the rear camera will show the true rear view image where the license plates of vehicles behind your vehicle are inverted. Actual recorded images are horizontally flipped to capture the license plate correctly.

4.5.2 REAR CAMERA WIRING DIAGRAM

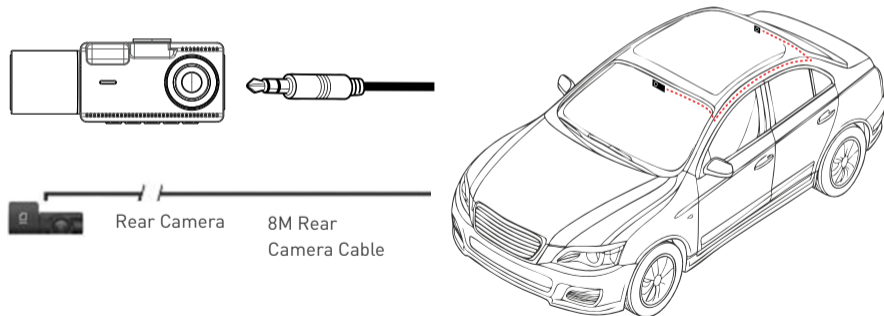

4.5.3 REAR CAMERA FEATURES

After successfully installing and connecting the rear camera its image will be displayed on the front Dash Camera's screen.

All three cameras will instantaneously start recording after the front Dash Camera is powered ON. Front camera image will initially be displayed on the screen, but you can switch between the three camera images by pressing the Button.

THE DISPLAY CAN SWITCH BETWEEN:

1. Full front camera view.
2. Full rear camera view.
3. Full in-cabin camera view.
4. Front camera + rear camera view + in-cabin camera view.

NOTES:

- The NCP-DVR30CH rear camera is designed to be constantly powered by the included DC Power Plug.

5.0 POWERING ON/OFF

5.1 AUTO POWER ON/OFF

When the front Dash Camera is correctly installed and connected to your vehicle's power supply, it will automatically power up and start recording when the vehicle accessories are activated.

5.2 MANUAL POWER ON

Hold the  button on the bottom left hand side of the camera until the Nanocam+ start up screen appears.

5.3 MANUAL POWER OFF

Hold and press  button. After powering down the device, please wait for 10 seconds before turning the Dash Camera back on.

5.4 RESETTING THE DASH CAMERA

If the front Dash Camera does not function normally, try restarting it by using a small pin, press and hold the  button on the left side of the camera.

6.0 INITIAL SETTINGS

Before using the front Dash Camera we recommend formatting the inserted Micro SD card and setting the correct Time and Date.

6.1 FORMATTING THE INSERTED MICRO SD CARD

Formatting the Micro SD card will delete all information on the inserted Micro SD card and prepare the card for use with the Dash Camera.

1. Press the button to enter the Settings.
2. Press the button to toggle to System Settings, and press the button to enter System Menu.
3. Use the and button to navigate the Settings Menu and highlight the Format setting, then press the button to select.
4. Select SD Card and press the button.
5. Press the button to confirm.

NOTES:

- Formatting your Micro SD card will delete all files from the card. Once these files have been deleted you will not be able to recover them.

7.0 SETTING THE TIME AND DATE

Setting the Time and Date allows you to stamp your footage with the time and date as a reference. Date and time stamps are important, especially when using your footage in an insurance claim.

1. Press the button to enter the Settings.
2. Press the button to toggle to System Settings, and press the button to enter System Menu.
3. Use the and button to navigate the Settings Menu and highlight the Date/Time setting, then press the button

Use the and buttons to edit the selected digit and the button to confirm and progress to the next digit. The final field will set the format that the time will be presented in, and pressing the button with this field highlighted will save the date and revert to the settings menu.

NOTES:

- Once the time and date is set, it can be stamped onto your footage using the Date Stamp setting.

8.0 VIDEO MODE

When the front Dash Camera is powered ON, the video screen will start by default. In this screen, recording will automatically start. To access the Video Menu, press the Button.

9.0 INTERFACE

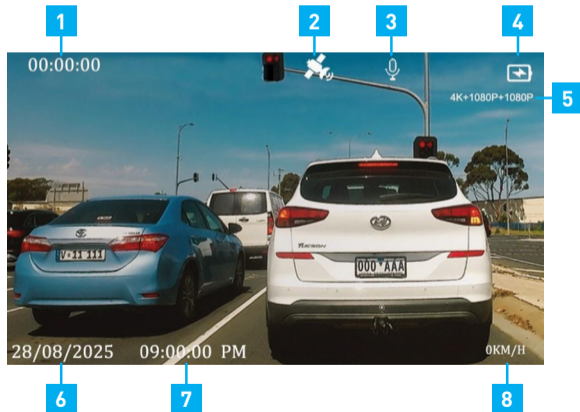

9.1 VIDEO MODE

1. **Duration:** 00:00:00 Loop Recording timer and also indicates if the Dash Camera is recording when highlighted red.
2. **GPS:** Indicates the GPS connected or not.
3. **Microphone:** Turns microphone on or off.
4. **Battery:** indicates battery level.
5. **Resolution:** To show the video resolution.
6. **Date:** {28/08/2025}
7. **Time:** {09:00:00}
8. **Speed:** To show the speed.

9.2 SETUP MENU

1. Press the button to enter into the Settings Menu.
2. Press the and buttons to select the Record menu or System menu.
3. Press button on your selected option.
4. Press the and buttons to select the setting you wish to change.

10.0 RECORD SETTINGS

| Menu | Setting Options | Description |
|--------------------|---------------------------|--|
| Resolution | 4K+1080P+1080P | 4K resolution deliver sharp and detailed images. |
| Loop Recording | 1 min / 2 mins / 3 min | Loop Recording defines the length of time the unit records before creating a new file. Default: 1 min |
| Cam Display | Front+ Inside+ Rear | See every angle recorded in clear detail. |
| Audio Recording | On / Off | Turning this setting off mutes the built in microphone. Default: On |
| Watermark Stamp | On / Off | Select On/Off to have the date and time stamped on or off the recorded video. Default: On |
| Number Plate Stamp | On / Off | Input your car number plate and it will be stamped on the recorded footage. Default: On |
| G-sensor | Off / Low / Medium / High | Adjust the sensitivity of the G-sensor. High is the highest sensitivity and Low is the lowest. Default: Low |
| IR LED | Off / On | Infra-red night vision in-cabin camera records in low light. Default: On |

| Menu | Setting Options | Description |
|----------------------------|-----------------------------|--|
| Parking Monitor | On / Off | Requires a 3-wire hard wire kit (NCP-SHWK, not provided). When park mode is turned on and the car detects the engine is off, it enters stand-by state: turns on and records video when an impact is detected. |
| Time-lapse On/Off | Off / 1 sec / 2 sec / 3 sec | This menu will appear after connecting a 3-wire hardwire kit (NCP-SHWK, not provided). When time-lapse mode is turned on (1S/2S/3S) and the car detects the engine is off, the recording will be done in time-lapse mode. This is to save memory space when the car is parked. |
| Time-lapse Duration | Off / 12 hr / 24 hr / 48 hr | This menu will appear after connecting a 3-wire hardwire kit (NCP-SHWK, not provided). When the car is parked, it will stop recording after the set time-lapse duration has passed. If set to OFF, the time-lapse mode will remain on until cut off voltage is detected. |

SYSTEM SETTINGS

| Menu | Setting Options | Description |
|------------------------------|-------------------------------|---|
| Screen Saver | Off / 30 sec / 1 min / 3 min | Turns off display when turned On. Dash cam will continue recording. Default: Off |
| Date and Time Setting | | Set Date and Time to have it watermarked on recorded footage. |
| Time system | 12 hr System/ 24 hr System | Enables you to choose and set your time preference. |

| Menu | Setting Options | Description |
|----------------------|-----------------------------|---|
| Beep Sound | | Mutes control for button beeps. Default: On |
| GPS information | | Provides an indication on GPS signal strength. |
| Speed Unit | Off / KM/H / MPH | KM/H |
| Format Micro SD card | | Formatting the Micro SD card will delete all photos, videos and data. |
| Factory settings | Off / 1 sec / 2 sec / 3 sec | A complete factory reset will erase all settings and return device to its original state. |
| About Dash Cam | Off / 12 hr / 24 hr / 48 hr | Displays installed firmware version to confirm if an update is available on our website. |

11.0 PLAYBACK

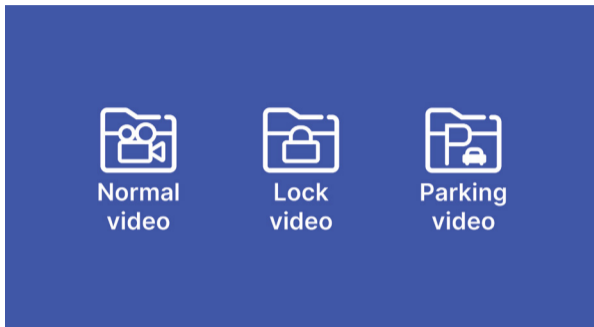

1. Press and hold button to enter Playback Mode.
2. Press and buttons to select desired file folders to be played back and then press button to confirm.
3. Press the and buttons to select the desired file to be played back.
4. Press button to playback the selected video file and then press again to pause.

12.0 SOFTWARE PLAYBACK

The GPS Add-On unit will record your vehicle's speed and GPS location for playback alongside your footage when viewed on a computer.

GPS player will be copied on the Micro SD card when correctly formatted in the front Dash Camera. To view recorded videos, you'll need to remove the Micro SD Card and transfer the files to your computer using a Micro SD card slot or compatible USB adapter.

Once files have been transferred to your computer, please select the folder and the file you wish to view or playback.



13.0 WARRANTY TERMS & CONDITIONS

Our goods come with guarantees that cannot be excluded under the Australian Consumer Law.

You are entitled to a replacement or refund for a major failure and for compensation for any other reasonably foreseeable loss or damage. You are also entitled to have the goods repaired or replaced if the goods fail to be of acceptable quality and the failure does not amount to a major failure. This warranty is provided in addition to your rights under the Australian Consumer Law.

Directed Electronics Australia Pty Ltd (Directed Electronics) warrants that this product is free from defects in material and workmanship for a period of 12 months from the date of purchase or for the period stated on the packaging. This warranty is only valid where you have used the product in accordance with any recommendations or instructions provided by Directed Electronics.

This warranty excludes defects resulting from alterations of the product, accident, misuse, abuse or neglect. In order to claim the warranty, you must return the product to the retailer from which it was purchased or if that retailer is part of a National network, a store within that chain, along with satisfactory proof of purchase. The retailer will then return the goods to Directed Electronics.

Directed Electronics will repair, replace or refurbish the product at its discretion. The retailer will contact you when the product is ready for collection. All costs involved in claiming this warranty, including the cost of the retailer sending the product to Directed Electronics, will be borne by you.

Ph: +610383314800 | Email: infolananocamplus.com.au

13.1 INDEMNITY

You agree to defend, indemnify and hold harmless Nanocam+ and its subsidiaries and affiliates from and against any and all claims, proceedings, injuries, liabilities, Losses, costs and expenses including reasonable legal fees), including but not limited to, claims alleging negligence, invasion of privacy, copyright infringement and/or trademark infringement against Nanocam+ and its subsidiaries and affiliates, relating to or arising out of your breach of any provision of these terms, your misuse of Nanocam+ products or its services, or your unauthorised modification or alteration of products or software.

13.2 WARRANTY AND WARRANTY DISCLAIMER

Nanocam+ has a limited warranty, where by Nanocam+ warrants to you and only to you that this Nanocam+ product will be free from defects in materials and workmanship for one year from the date of your purchase (unless a longer warranty period is required by law). The specifics of this Nanocam+ limited warranty are covered in this manual.

To the extent possible under governing law, other than the above product warranty for the Nanocam+ product you understand and agree that the Nanocam+ products and services are provided on an “as is” and “as available” basis. Nanocam+ makes no warranty that the Nanocam+ products and services will meet your requirements or that use of the Nanocam+ products and services will be uninterrupted, timely, secure or error-free. Nor does Nanocam+ make any warranty as to the accuracy or reliability of any information obtained through Nanocam+ (including third party content), that any defects in the Nanocam+ products or services be corrected or that the Nanocam+ products or Nanocam+ services will be compatible with any other specific hardware or service. Further, Nanocam+ does not warrant that Nanocam+ products or services or Nanocam+ servers that provide you with data and content are free of viruses or other harmful components.

Nanocam+ also assumes no responsibility for and shall not be liable, for any damages caused by viruses that may infect your Nanocam+ product or software. In the event of any loss, damage or injury, you will not look to Nanocam+ to compensate you or anyone else. You release and waive for yourself and your insurer all subrogation and other rights to recover against Nanocam+ arising as a result of the payment of any claim for loss, damage or injury. Nanocam+ equipment and services do not cause and cannot eliminate occurrences of certain events and Nanocam+ makes no guarantee or warranty, including any implied warranty of merchantability or fitness for a particular purpose or that Nanocam+ equipment and services provided will detect or avert such incidents or their consequences.

Nanocam+ does not undertake any risk that you or property, or the person or property of others, may be subject to injury or loss if such an event occurs. The allocation of such risk remains with you, not Nanocam+. Other than the above product warranty for Nanocam+ products, its suppliers disclaim all warranties of any kind, whether express, implied, or statutory, regarding the Nanocam+ products and services, including any implied warranty of title, merchantability, fitness for a particular purpose, or non-infringement of third-party rights. Because some jurisdictions do not permit the exclusion of implied warranties, the last sentence of this section may not apply to you.

Nanocam+ hereby further expressly disclaims all liability for any claims for service failures that are due to normal product wear, product misuse, abuse, product modification improper product selection or your noncompliance with all applicable federal, state or local laws. This warranty and warranty disclaimer give you specific legal rights, and you may have other rights that vary by state, province, or country. Other than as permitted by law, Nanocam+ does not exclude, limit or suspend other rights you have, including those that may arise from the nonconformity of a sales contract. For a full understanding of your rights, you should consult the laws of your state, province, or country.

13.3 LIMITATIONS OF NANOCAM+ LIABILITY

Under no circumstances will Nanocam+ be liable in any way for any content, including, but not limited to, the loss of content, any errors or omissions in any content, or any loss or damage of any kind incurred in connection with use of or exposure to any content posted, emailed, accessed, transmitted, or otherwise made available via Nanocam+. Nanocam+ liability for damages, especially for breach of duty or obligation, delay in performance, non-performance, or malperformance shall be precluded, except when these are due to negligent breaches of any significant contractual duty or obligation on the part of Nanocam+. Any liability for negligence is limited to direct losses usually and typically foreseeable in such case.

Should the claim for damages be based on wilful or grossly negligent breach of contractual duty or obligation on the part of Nanocam+, the preclusion and limitation of liability mentioned in the preceding sentences will not apply. The preceding preclusion and limitation of liability will also not apply to claims for damages arising out of loss of life, bodily injury or health impacts for which Nanocam+ may be liable, or for non-contractual liability.

Some states and countries do not allow the exclusion or limitation of incidental or consequential damages, so the above limitation or exclusion may not apply to you. Additionally, this provision is not intended to limit Nanocam+'s liability in the event of Nanocam+'s wilful or intentional misconduct.

14.0 NOTES

Connecting your drive.

www.nanocamplus.com.au | www.nanocamplus.co.nz



All Images, Information and Content are Copyright © 2025
Directed Electronics Australia Pty Ltd. All Rights Reserved.

NANOCAM+ | ANOTHER
DIRECTED
BRAND

DIRECTED
AUSTRALIA & NZ

www.directed.com.au
www.directed.co.nz